

## References

## ESO Supernova Planetarium

The ESO Supernova Planetarium and Visitor Center in Garching near Munich is designed to teach the public about astronomy in a vivid and exciting way. The building, designed by architects Bernhardt und Partner from Darmstadt, models a binary star system in which one star is transferring its mass to the other.

### Facts

Area	Architecture
Location	Munich, DE
Year of manufacture	2021
Architect	Bernhardt

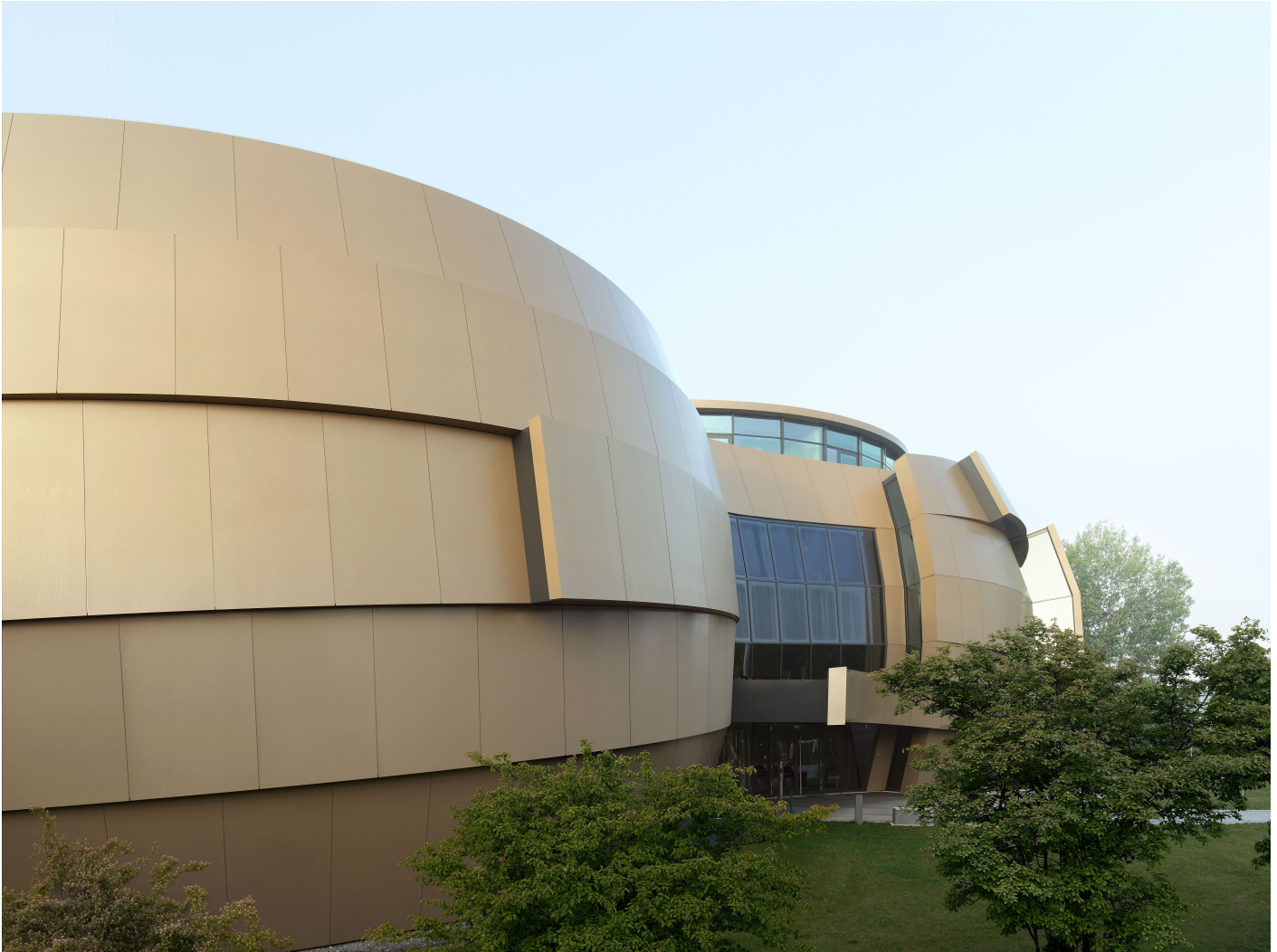

## Details

The heavier star will eventually explode in a supernova, producing more light than all the millions of stars in our galaxy combined. The ESO Supernova is a partnership between the European Southern Observatory (ESO) and the Heidelberg Institute for Theoretical Studies (HITS). With an exhibition area of over 2,000 square meters, a state-of-the-art digital fulldome planetarium for 109 people, and rooms for conferences and workshops, it offers visitors fascinating insights into astronomy.



You can find more interesting references on our website.  
<https://www.igp-powder.com/en/reference/49809/eso-supernova-planetarium>

If you have any questions, please contact us at any time, we will be happy to advise you.

